

MPF PRODUCTS INC.

FIBER CONSTRUCTION

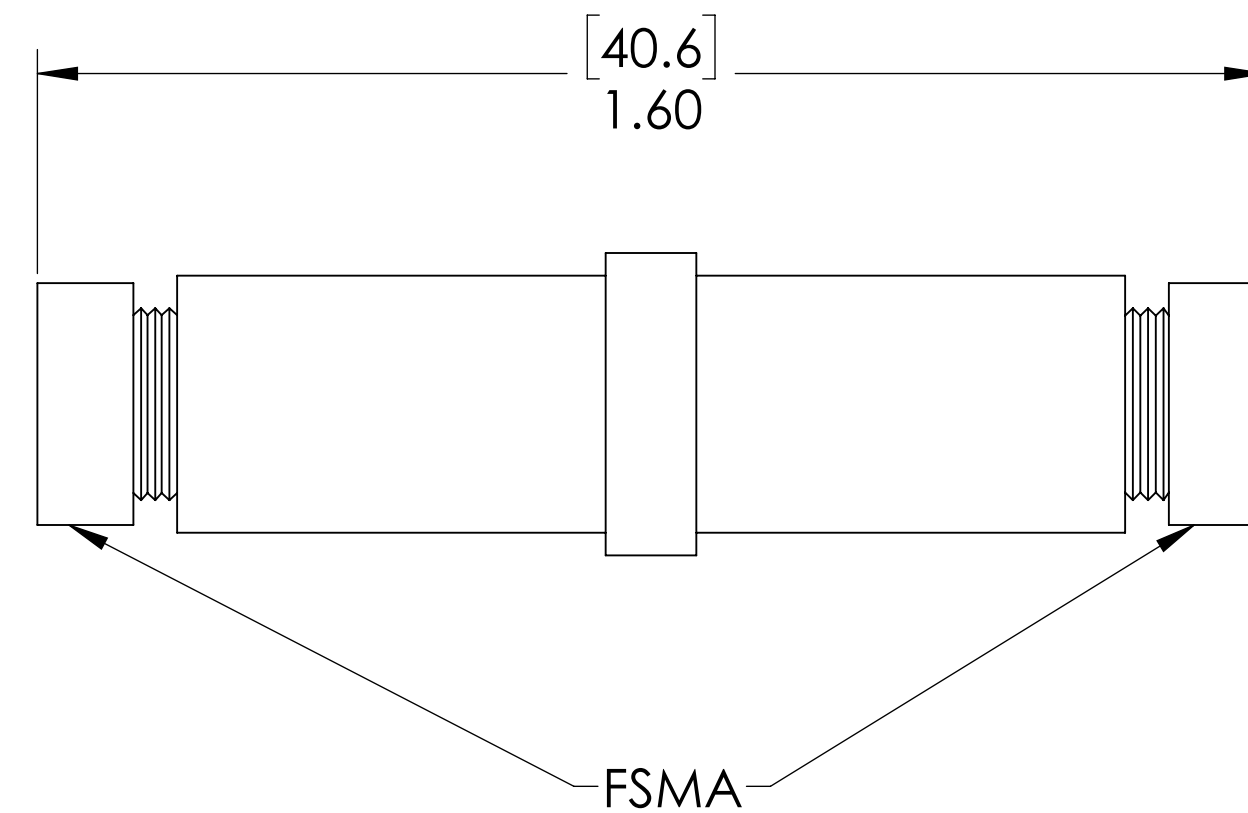
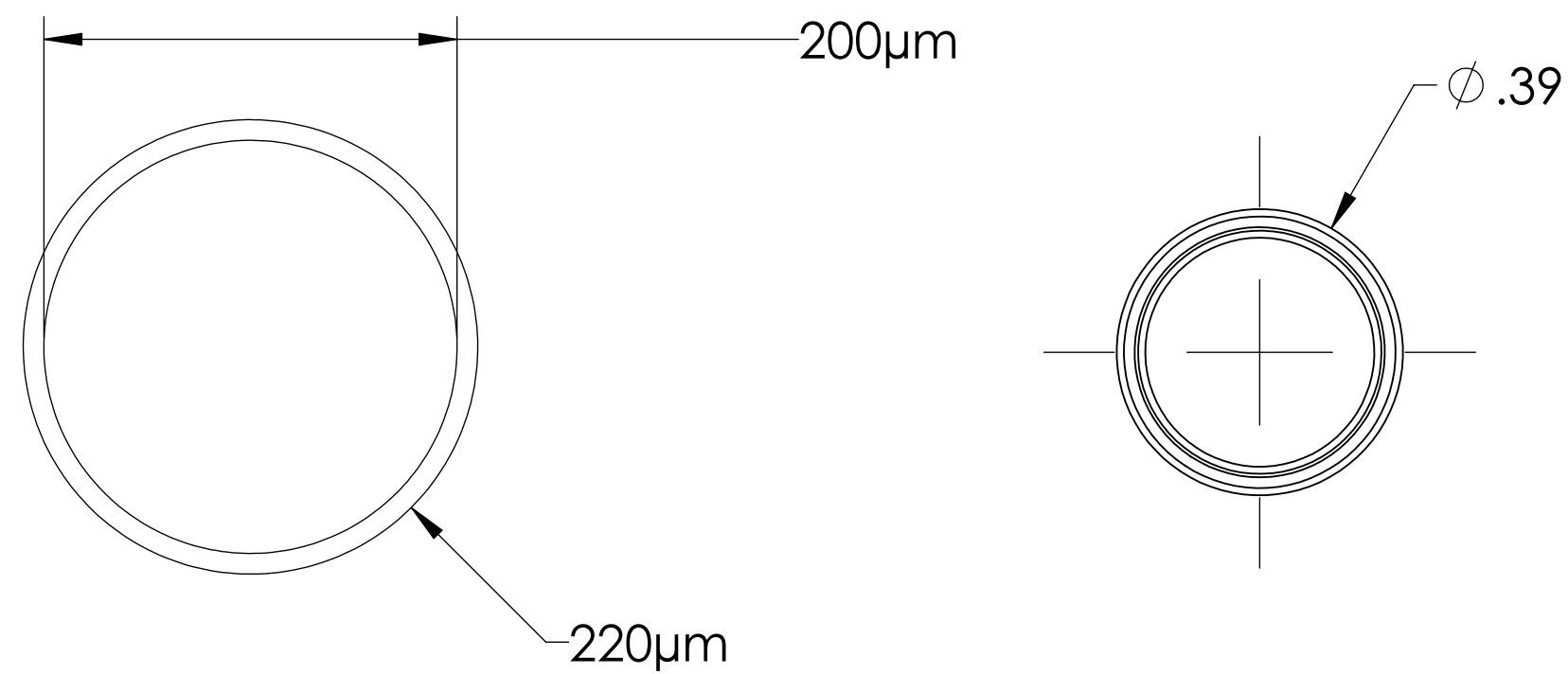

MM200 UV FSMA NOTES:

1. WAVELENGTH RANGE: 190nm TO 1100nm
2. NUMERICAL APERTURE: 0.22
3. TYPICAL INSERTION LOSS: <1.2 dB
4. FERRULE: 2.5mm CERAMICS (ZrO2)

Multimode (MM200) UV Fiber Optic Feedthrough, FSMA Connector

UNLESS OTHERWISE SPECIFIED:		QUOTATION #		N/A	
DIMENSIONS ARE IN INCHES TOLERANCES:		NAME	DATE	MPF PRODUCTS INC.	
ANGULAR: MACH ± 1/2°		DRAWN	9/11/2015		
TWO PLACE DECIMAL ± .030		CHECKED	9/11/2015		
THREE PLACE DECIMAL ± .015		ENG APPR.	9/11/2015		
MATERIAL		THIRD ANGLE:		MULTIMODE FIBER OPTIC FEEDTHROUGH (FIBER MM200) DOWNLOADED FROM MPFPI.COM	
		APPLICATION			
FINISH		SURFACE FINISH: 63 OR BETTER		DWG. NO.	REV.
PLATING		UNLESS OTHERWISE SPECIFIED:		A14876-1-W	
		ALL DIAMETERS CONCENTRIC WITHIN .005. REMOVE ALL BURRS AND SHARP EDGES		Friday, July 26, 2019 10:39:52 AM	