

MPF PRODUCTS INC.

FIBER CONSTRUCTION

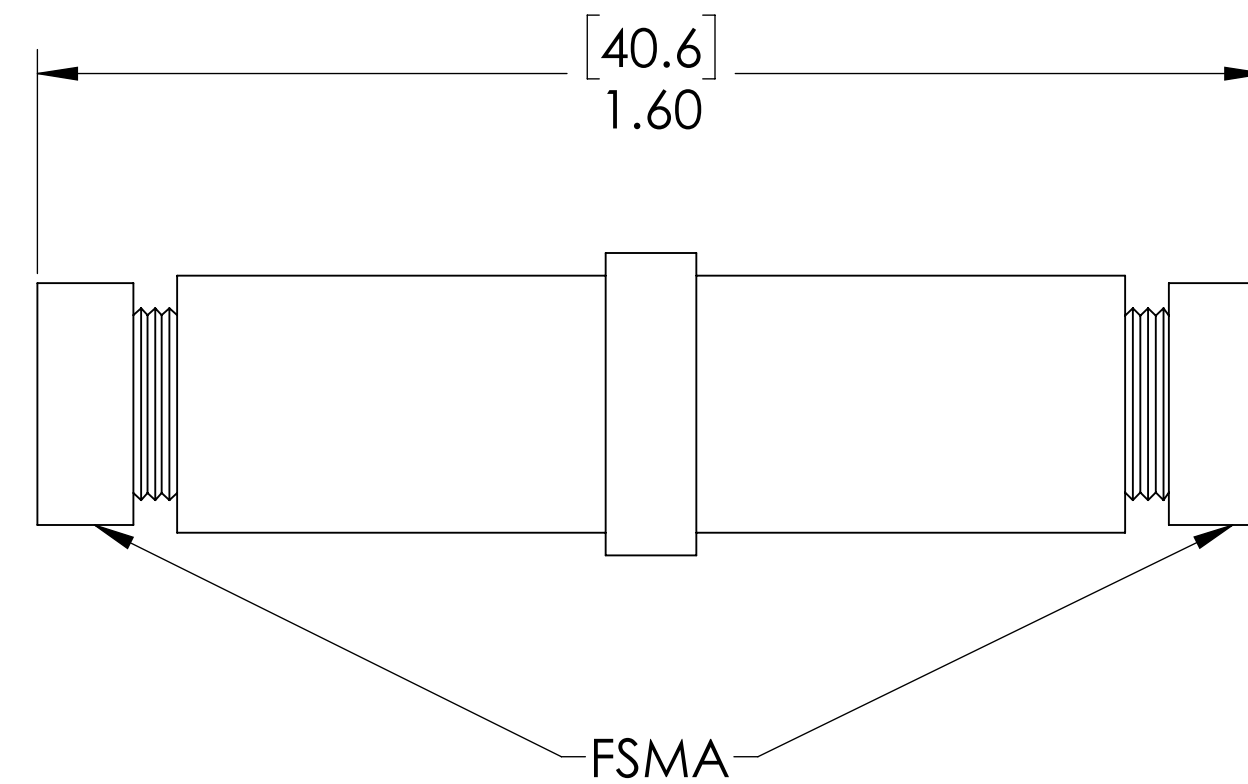
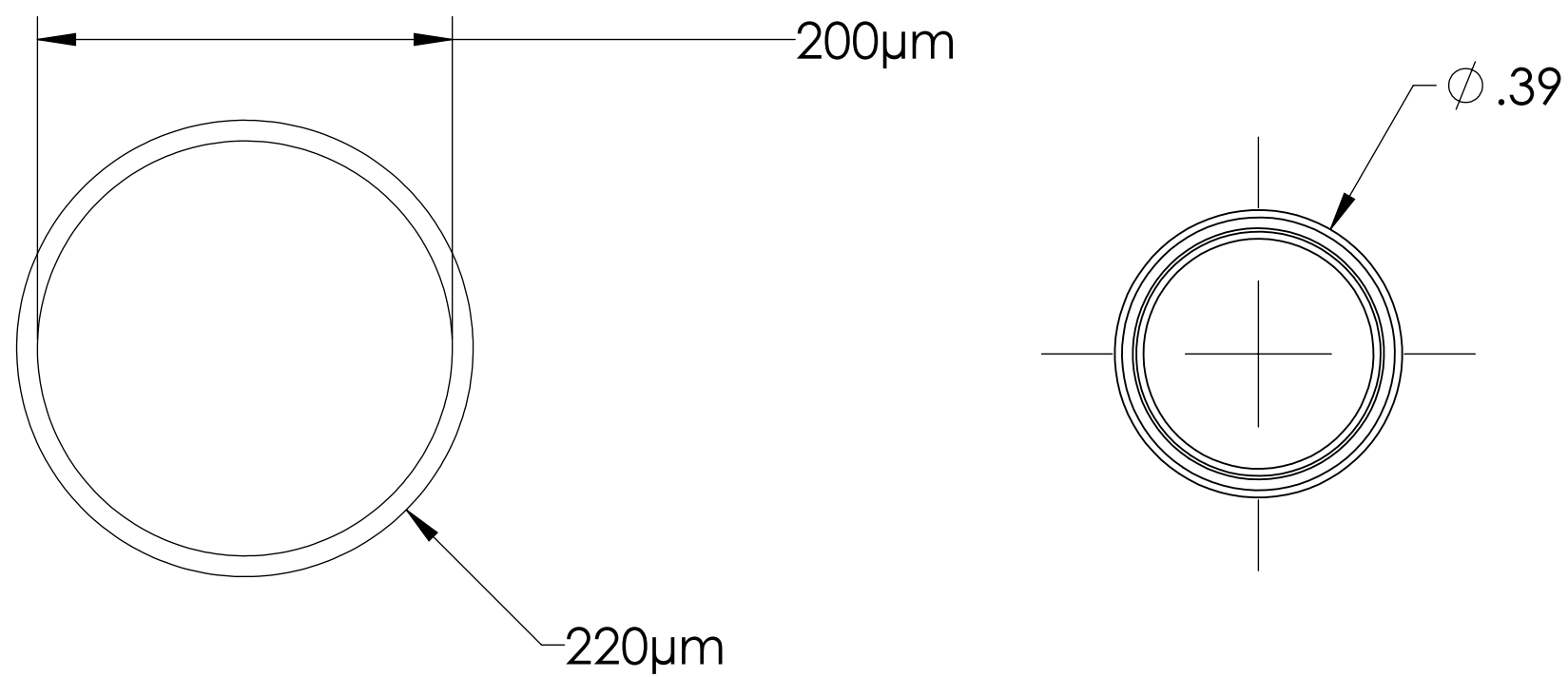

MM200 IR FSMA NOTES:

1. WAVELENGTH RANGE: 400 TO 2400nm
2. NUMERICAL APERTURE: 0.22
3. TYPICAL INSERTION LOSS: <1.2 dB
4. FERRULE: 2.5mm CERAMICS (ZrO2)

Multimode (MM200) IR Fiber Optic Feedthrough, FSMA Connector

UNLESS OTHERWISE SPECIFIED:		QUOTATION #		N/A	
DIMENSIONS ARE IN INCHES TOLERANCES:		NAME	DATE	MPF PRODUCTS INC.	
ANGULAR: MACH ± 1/2°		DRAWN	9/11/2015		
TWO PLACE DECIMAL ± .030		CHECKED	9/11/2015		
THREE PLACE DECIMAL ± .015		ENG APPR.	9/11/2015		
MATERIAL		THIRD ANGLE:		MULTIMODE FIBER OPTIC FEEDTHROUGH (FIBER MM200)	
		APPLICATION NEXT ASSY USED ON			
FINISH		SURFACE FINISH: 63/ OR BETTER		DOWNLOADED FROM MPFPI.COM	
PLATING		UNLESS OTHERWISE SPECIFIED:		DWG. NO. REV	
		ALL DIAMETERS CONCENTRIC WITHIN .005. REMOVE ALL BURRS AND SHARP EDGES		A14876-19-W	
				Friday, July 26, 2019 10:39:29 AM	