

MPF PRODUCTS INC.

FIBER CONSTRUCTION

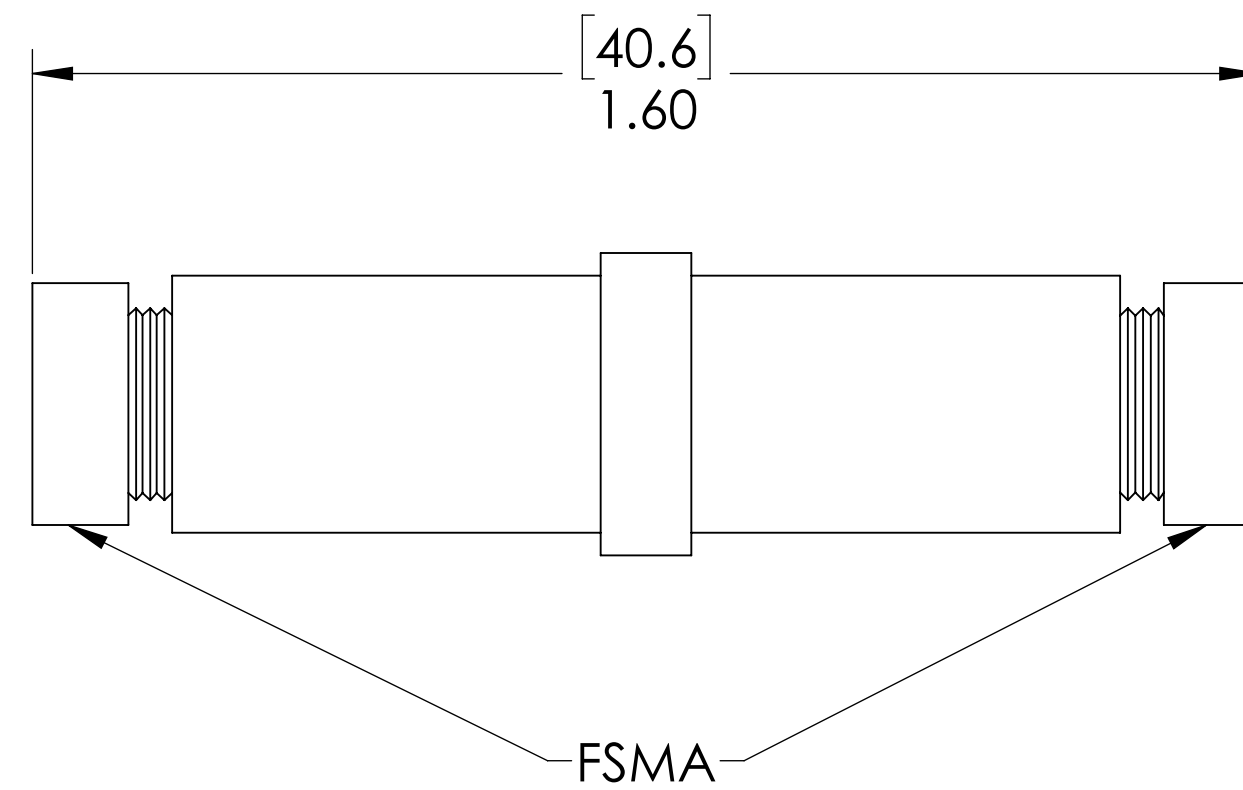
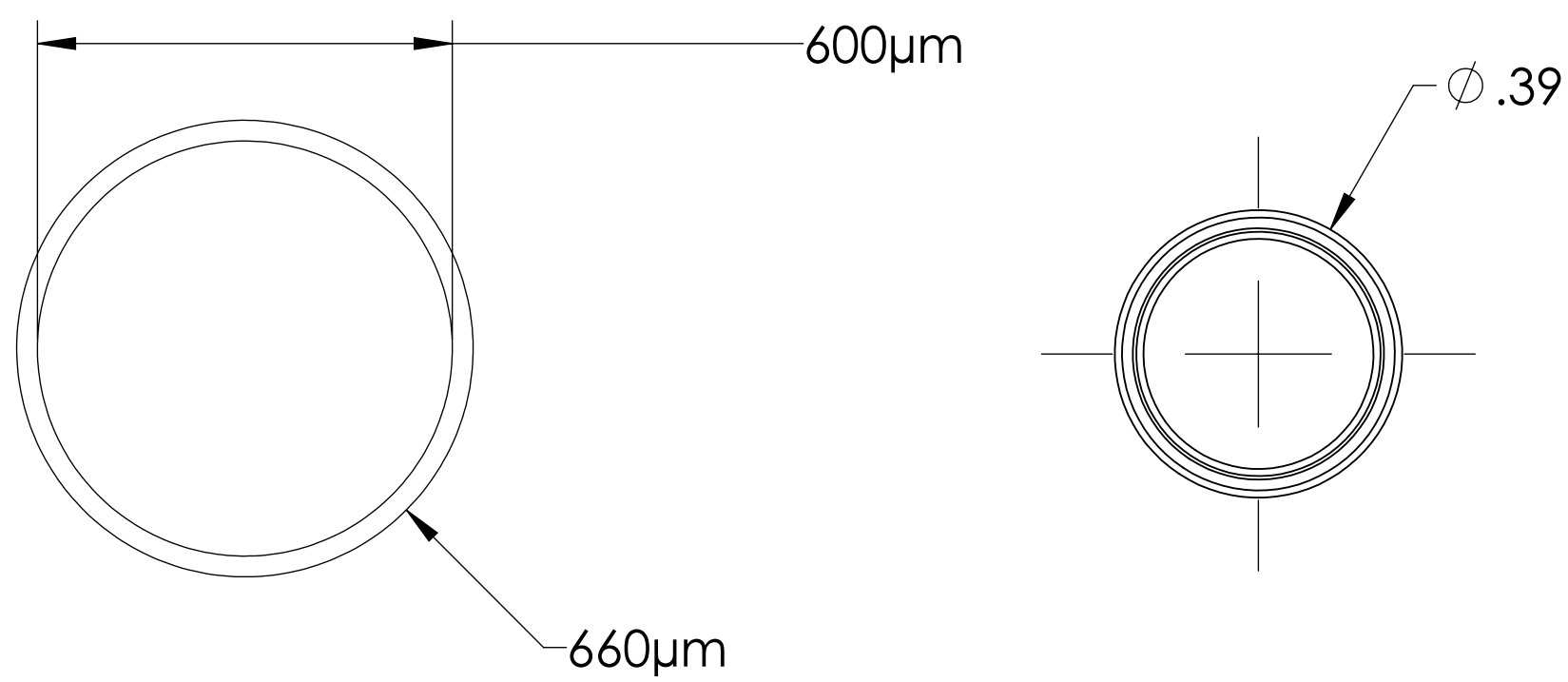

MM600 UV FSMA NOTES:

1. WAVELENGTH RANGE: 190nm TO 1100nm
2. NUMERICAL APERTURE: 0.22
3. TYPICAL INSERTION LOSS: <1.2 dB
4. FERRULE: 2.5mm CERAMICS (ZrO2)

Multimode (MM600) UV Fiber Optic Feedthrough, FSMA Connector

UNLESS OTHERWISE SPECIFIED:		QUOTATION #		N/A	
DIMENSIONS ARE IN INCHES		NAME	DATE	MPF PRODUCTS INC.	
TOLERANCES:		DRAWN	9/11/2015		
ANGULAR: MACH ± 1/2°		CHECKED	9/11/2015		
TWO PLACE DECIMAL ± .030		ENG APPR.	9/11/2015		
THREE PLACE DECIMAL ± .015		THIRD ANGLE:		TITLE: MULTIMODE FIBER OPTIC FEEDTHROUGH (FIBER MM600) DOWNLOADED FROM MPFPI.COM DWG. NO. A14878-1-W REV	
MATERIAL					
FINISH		APPLICATION			
PLATING		NEXT ASSY USED ON			
SURFACE FINISH:		63/ OR BETTER		FRIDAY, JULY 26, 2019 10:38:57 AM	
UNLESS OTHERWISE SPECIFIED:		ALL DIAMETERS CONCENTRIC WITHIN .005.		REMOVED ALL BURRS AND SHARP EDGES	