

# MPF PRODUCTS INC.

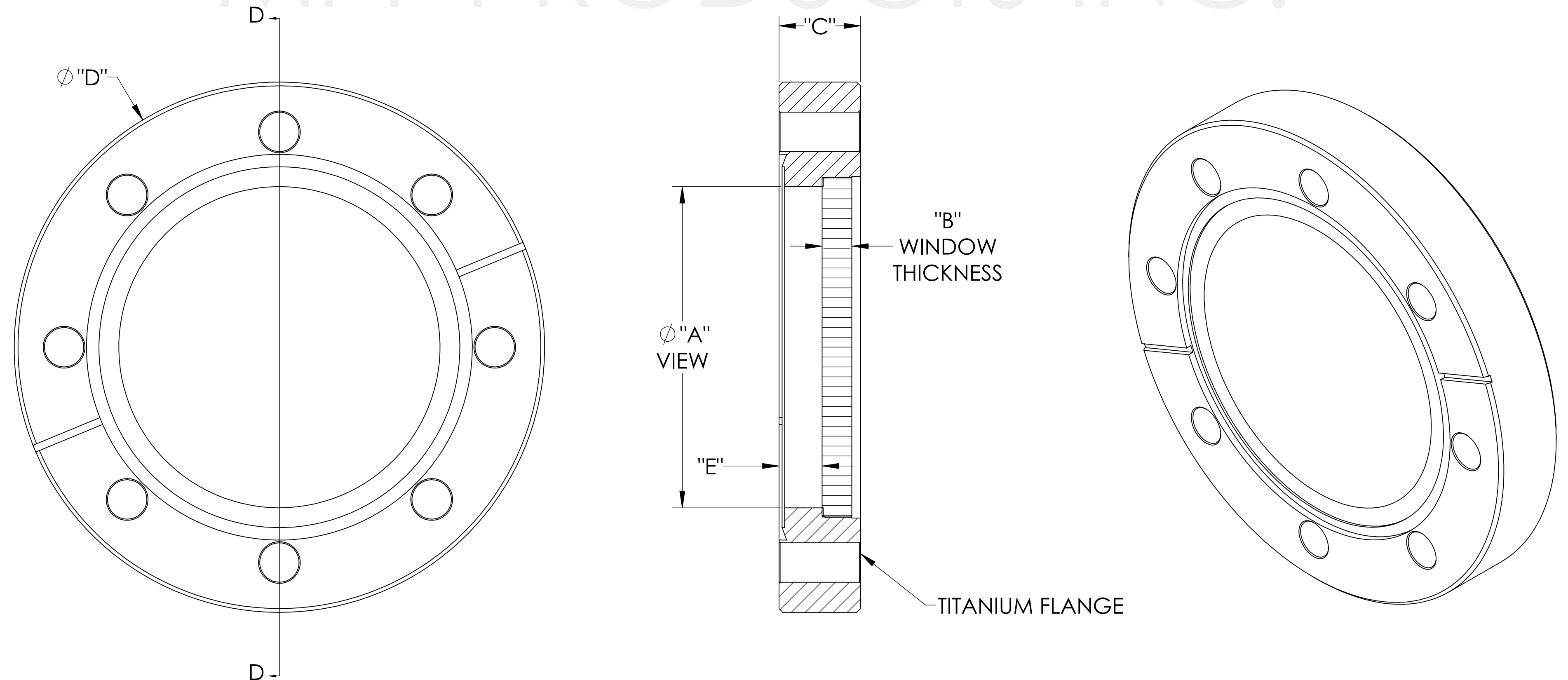

PART#	Ø "A" VIEW	"B"	"C"	"D"	"E"
A17426-1-CF	1.40	.13	.50	2.75	.35
A17426-2-CF	1.40	.13	.63	3.38	.35
A17426-3-CF	2.69	.25	.68	4.47	.42
A17426-4-CF	2.69	.25	.75	4.62	.42
A17426-5-CF	3.88	.25	.78	6.00	.51
A17426-6-CF	3.88	.25	.84	6.75	.51
A17426-7-CF	5.38	.37	.88	8.00	.48

**SPECIFICATIONS:**

1. MATERIAL: CORNING HPFS 7980 EXCIMER GRADE 193 FUSED SILICA
2. TWD <  $\lambda/4$  @ 632NM (PEAK TO VALLEY)
3. PARALLELISM < 10 ARC SECONDS
4. SURFACE FINISH: 20/10 SCRATCH-DIG
5. THERMAL RANGE: -100 °C TO 200 °C
6. TRANSMISSION > 99.5% @ 193NM (INTERNAL)
7. HOMOGENEITY GRADE: A
8. INCLUSION CLASS: 0
9. MAGNETIC PERMEABILITY ( $\mu$ ) < 1.001
10. LEAK RATE < 1 X 10<sup>-9</sup> ATM-CC/SEC HE

EUV Laser Grade (EUV) Fused Silica Viewport, All Titanium, Zero Length Profile, 1.40" 2.69", 3.88", 5.38" View Dia, Conflat Flange

UNLESS OTHERWISE SPECIFIED:	QUOTATION #	N/A	
DIMENSIONS ARE IN INCHES TOLERANCES:	NAME	DATE	<b>MPF PRODUCTS INC.</b>
ANGULAR: MACH ± 1/2"	DRAWN	9/11/2015	
TWO PLACE DECIMAL ± .030	CHECKED	9/11/2015	
THREE PLACE DECIMAL ± .015	ENG APPR.	WJ 9/11/2015	
MATERIAL	THIRD ANGLE:		
FINISH	APPLICATION	ALL TITANIUM VIEWPORT, FUSED SILICA, LASER GRADE (EUV), CF FLANGE	
PLATING	SURFACE FINISH: 63/ OR BETTER	DOWNLOAD FROM MPFPI.COM DWG. NO.	
	UNLESS OTHERWISE SPECIFIED:	A17426	
	ALL DIAMETERS CONCENTRIC WITHIN .005. REMOVE ALL BURRS AND SHARP EDGES	Tuesday, May 28, 2019 8:06:10 AM	