

MPF PRODUCTS INC.

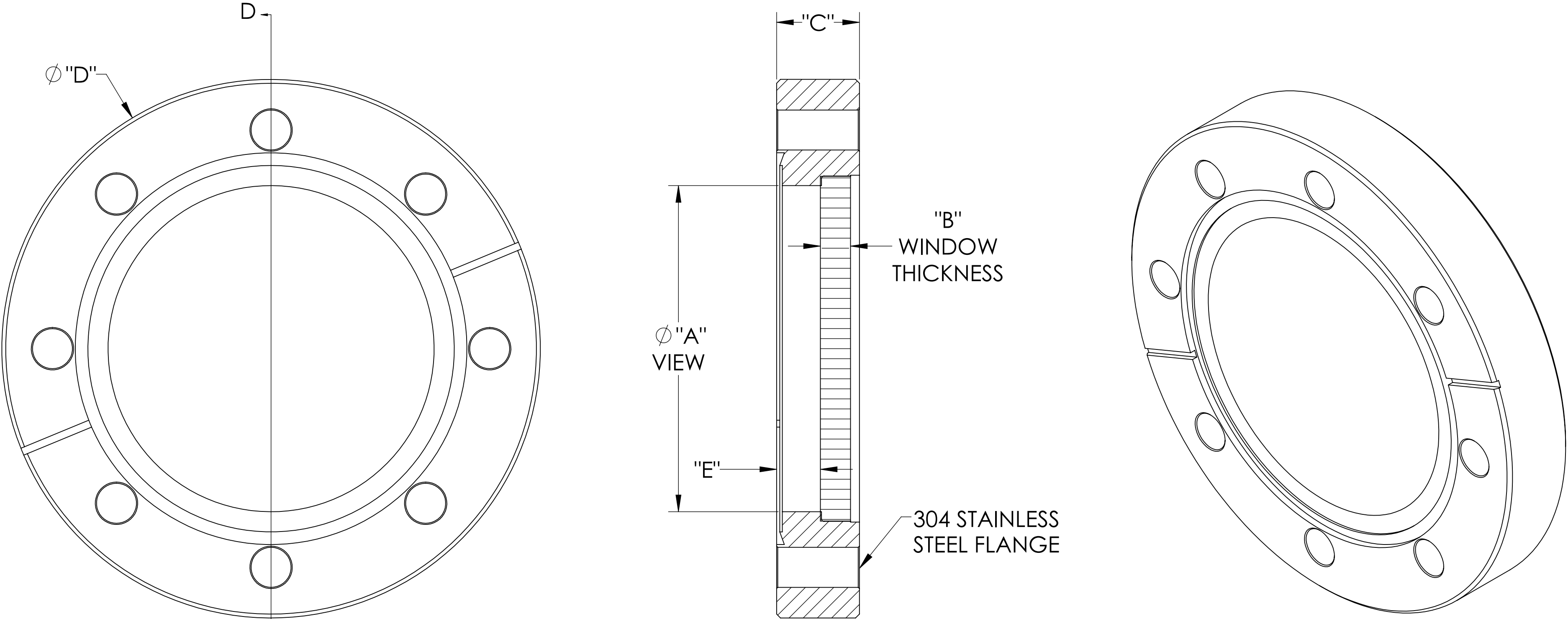

PART #	Ø "A" VIEW	"B"	"C"	"D"	"E"
A0650-1-CF	1.40	.13	.50	2.75	.35
A0650-2-CF	1.40	.13	.62	3.37	.35
A0650-3-CF	2.69	.25	.68	4.50	.41
A0650-4-CF	2.69	.25	.75	4.62	.41
A0650-5-CF	3.88	.25	.78	6.00	.51
A0650-6-CF	3.88	.25	.84	6.75	.51
A0650-7-CF	5.38	.37	.88	8.00	.48
A0650-8-CF	7.78	.37	.97	10.00	.53

SPECIFICATIONS:

- 1. MATERIAL: CORNING HPFS 7980 FUSED SILICA OR EQUIVALENT
- 2. TWD < λ/4 @ 632nm (PEAK TO VALLEY)
- 3. PARALLELISM < 10 ARC SECONDS
- 4. SURFACE FINISH: 20/10 SCRATCH-DIG
- 5. THERMAL RANGE: -100 °C TO 200 °C
- 6. HOMOGENEITY GRADE: A
- 7. INCLUSION CLASS: 0
- 8. LEAK RATE < 1 X 10-9 ATM-CC/SEC HE

Laser Grade Fused Silica Viewport, Zero Length Profile,1.40" 2.69", 3.88", 5.38", 7.78" View Dia, Conflat Flange

UNLESS OTHERWISE SPECIFIED:		QUOTATION #		N/A	
DIMENSIONS ARE IN INCHES TOLERANCES:		DRAWN	NAME	DATE	MPF PRODUCTS INC.
ANGULAR: MACH ± 1/2°		CHECKED	WJ	9/11/2015	
TWO PLACE DECIMAL ± .030		ENG APPR.	WJ	9/11/2015	
THREE PLACE DECIMAL ± .015		THIRD ANGLE:			VIEWPORT, FUSED SILICA, LASER GRADE, CF FLANGE
MATERIAL					
FINISH		APPLICATION			
PLATING		NEXT ASSY			USED ON
		SURFACE FINISH: 63 OR BETTER			UNLESS OTHERWISE SPECIFIED:
		ALL DIAMETERS CONCENTRIC WITHIN .005. REMOVE ALL BURRS AND SHARP EDGES			ALL DIAMETERS CONCENTRIC WITHIN .005. REMOVE ALL BURRS AND SHARP EDGES
		DWG. NO.			REV
		A0650			
		Wednesday, October 14, 2020 10:58:18 AM			