

MPF PRODUCTS INC.

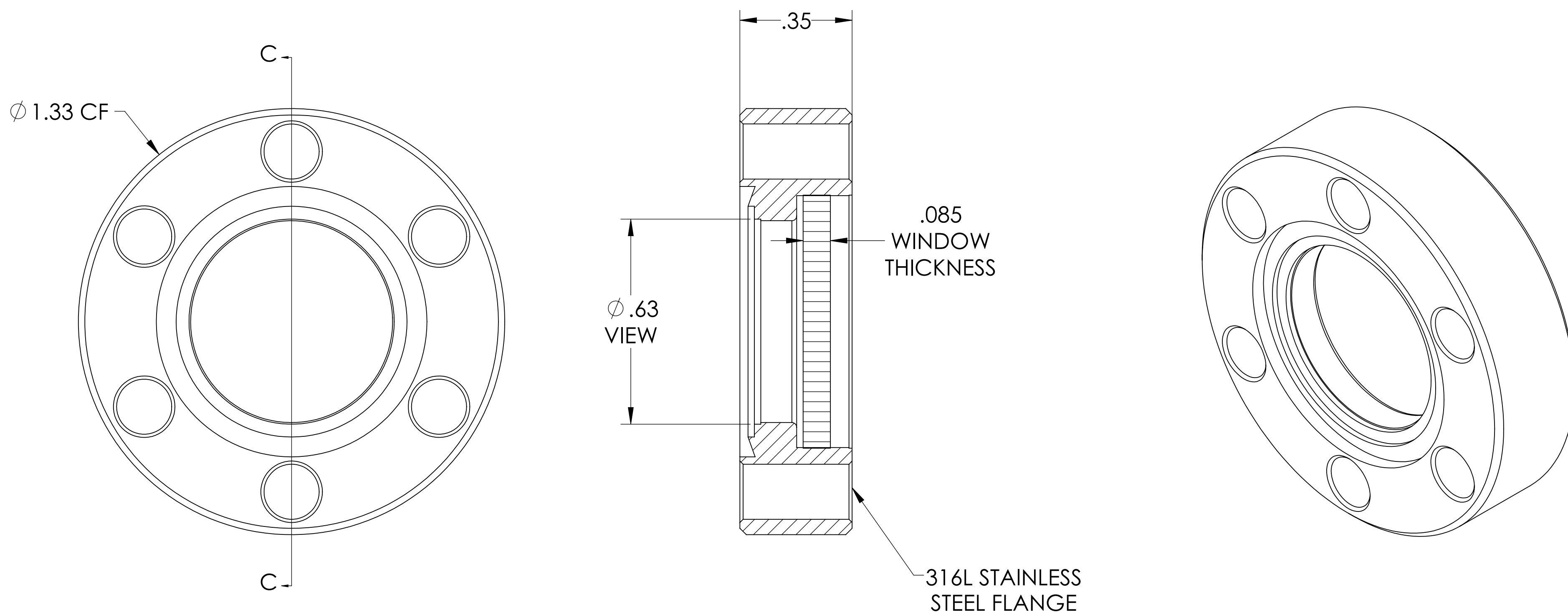

SPECIFICATIONS:

1. MATERIAL: CORNING HPFS 7980 EXCIMER 193nm FUSED SILICA
2. TWD < $\lambda/4$ @ 632nm (PEAK TO VALLEY)
3. PARALLELISM < 30 ARC SECONDS
4. SURFACE FINISH: 20/10 SCRATCH-DIG
5. THERMAL RANGE: -100 °C TO 200 °C
6. TRANSMISSION > 99.5% @ 193nm (INTERNAL)
7. HOMOGENEITY GRADE: A
8. INCLUSION CLASS: 0
9. LEAK RATE < 1 X 10⁻⁹ ATM-CC/SEC HE

EUV Laser Grade Fused Silica Viewport, Zero Length Profile, 0.63" View Dia, 1.33" Conflat Flange

| | | | |
|---|--|------|-----------|
| UNLESS OTHERWISE SPECIFIED: | QUOTATION # | N/A | |
| DIMENSIONS ARE IN INCHES TOLERANCES: | DRAWN | NAME | DATE |
| ANGULAR: MACH ± 1/2° | WJ | WJ | 9/11/2015 |
| TWO PLACE DECIMAL ± .030 | CHECKED | | 9/11/2015 |
| THREE PLACE DECIMAL ± .015 | ENG APPR. | WJ | 9/11/2015 |
| MATERIAL | THIRD ANGLE: | | |
| | | | |
| FINISH | APPLICATION | | |
| PLATING | NEXT ASSY USED ON | | |
| | SURFACE FINISH: 63 OR BETTER | | |
| | UNLESS OTHERWISE SPECIFIED: | | |
| | ALL DIAMETERS CONCENTRIC WITHIN .005. REMOVE ALL BURRS AND SHARP EDGES | | |
| | TITLE: | | REV |
| | VIEWPORT, FUSED SILICA, EUV LASER GRADE, 0.63" VIEW, 133 CF | | |
| | DWG. NO. | | |
| | A1671-3-CF | | |
| | DOWNLOADED FROM MPFPI.COM | | |
| | Wednesday, October 14, 2020 11:01:19 AM | | |