

MPF PRODUCTS INC.

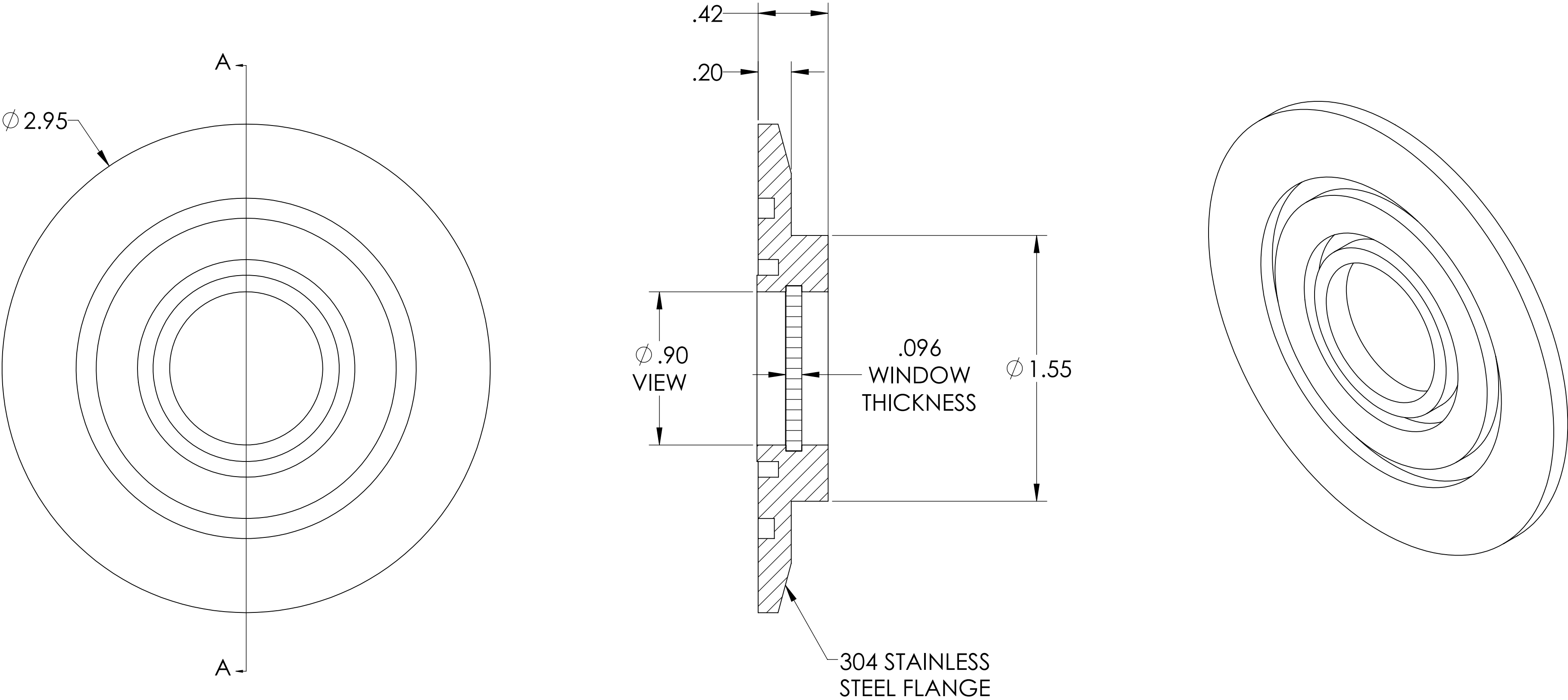

- SPECIFICATIONS:
- 1. MATERIAL: SINGLE CRYSTAL CALCIUM FLUORIDE
 - 2. TWD < $\lambda/2$ @ 632NM (PEAK TO VALLEY)
 - 3. PARALLELISM < 3 ARC MINUTES
 - 4. SURFACE FINISH: 20/10 SCRATCH-DIG
 - 5. THERMAL RANGE: -100°C TO 200°C
 - 6. LEAK RATE < 1 X 10-9 ATM-CC/SEC HE

Calcium Fluoride (CaF2) Viewport, UHV Rated Vacuum-Optics, 0.90" View Dia, 2.95" QF/KF

UNLESS OTHERWISE SPECIFIED:		QUOTATION #		N/A	
DIMENSIONS ARE IN INCHES TOLERANCES: ANGULAR: MACH $\pm 1/2^\circ$ TWO PLACE DECIMAL $\pm .030$ THREE PLACE DECIMAL $\pm .015$			NAME	DATE	MPF PRODUCTS INC. TITLE: VIEWPORT, CAF2 VACUUM OPTICS, 1" VIEW, QF/KF 50
		DRAWN	WJ	9/11/2015	
		CHECKED		9/11/2015	
		ENG APPR.	WJ	9/11/2015	
MATERIAL		THIRD ANGLE:			DOWNLOADED FROM MPFPI.COM DWG. NO. A4931-1-QF REV
		APPLICATION			
		NEXT ASSY USED ON			
FINISH		SURFACE FINISH: $\sqrt{63}$ OR BETTER			
PLATING		UNLESS OTHERWISE SPECIFIED:			
		ALL DIAMETERS CONCENTRIC WITHIN .005. REMOVE ALL BURRS AND SHARP EDGES			Wednesday, October 14, 2020 11:12:01 AM