

MPF PRODUCTS INC.

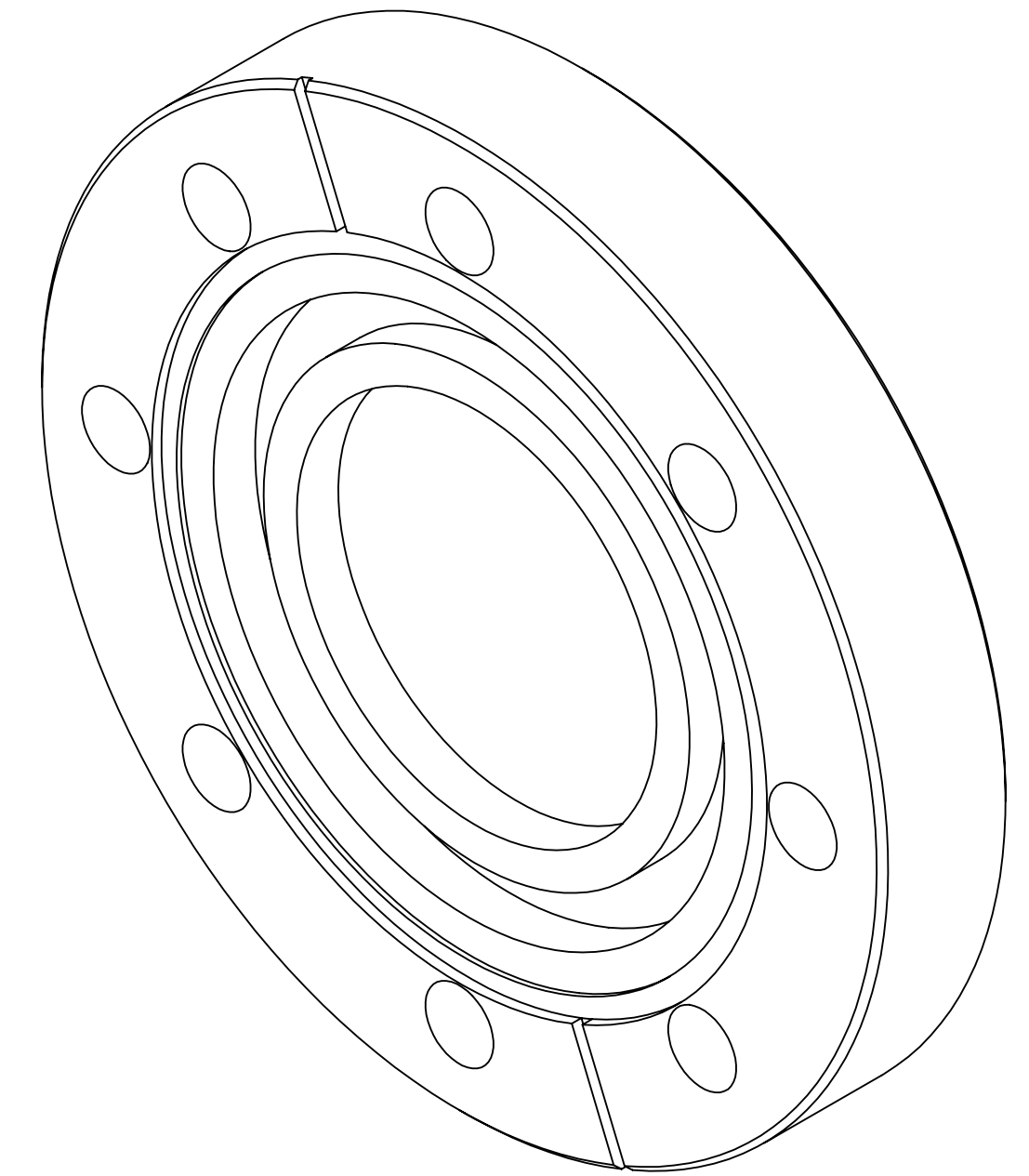
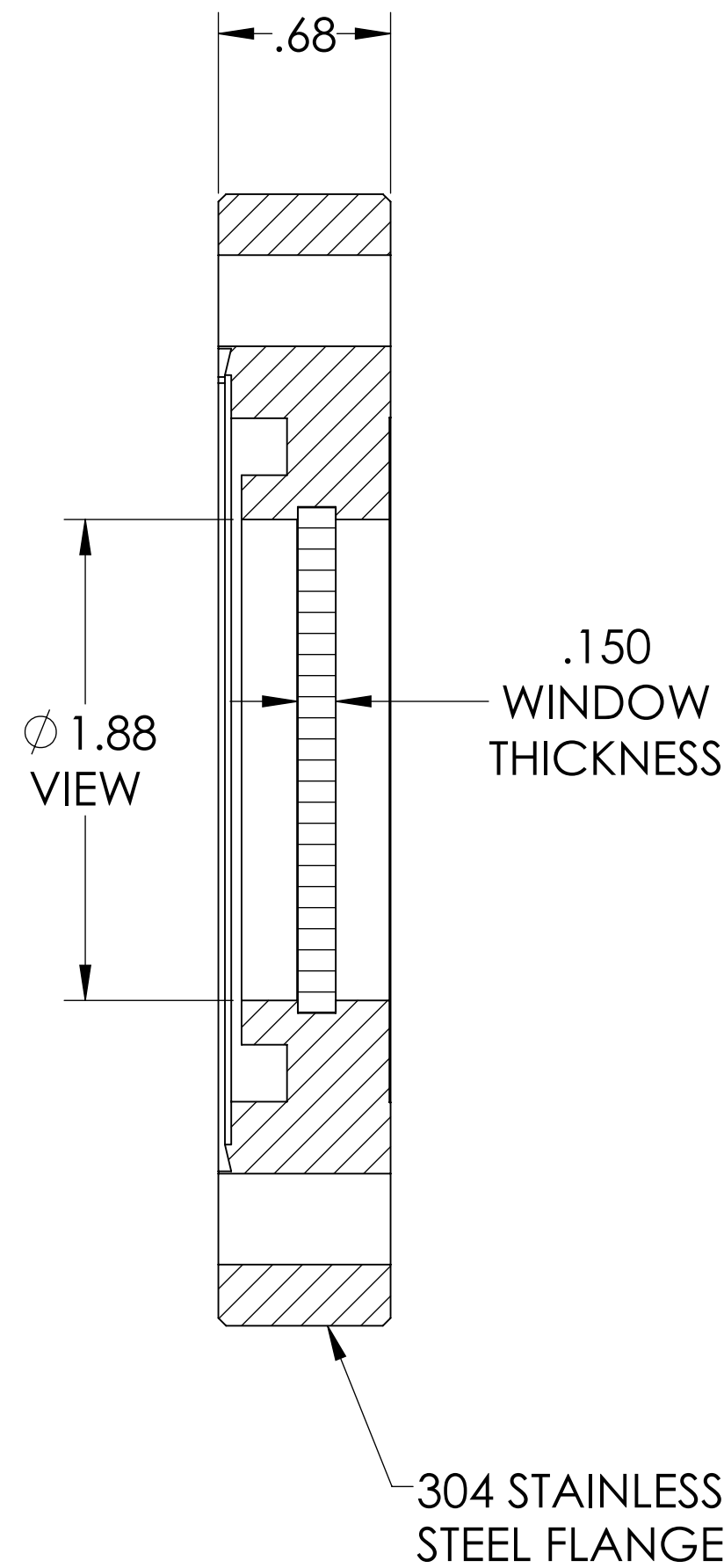
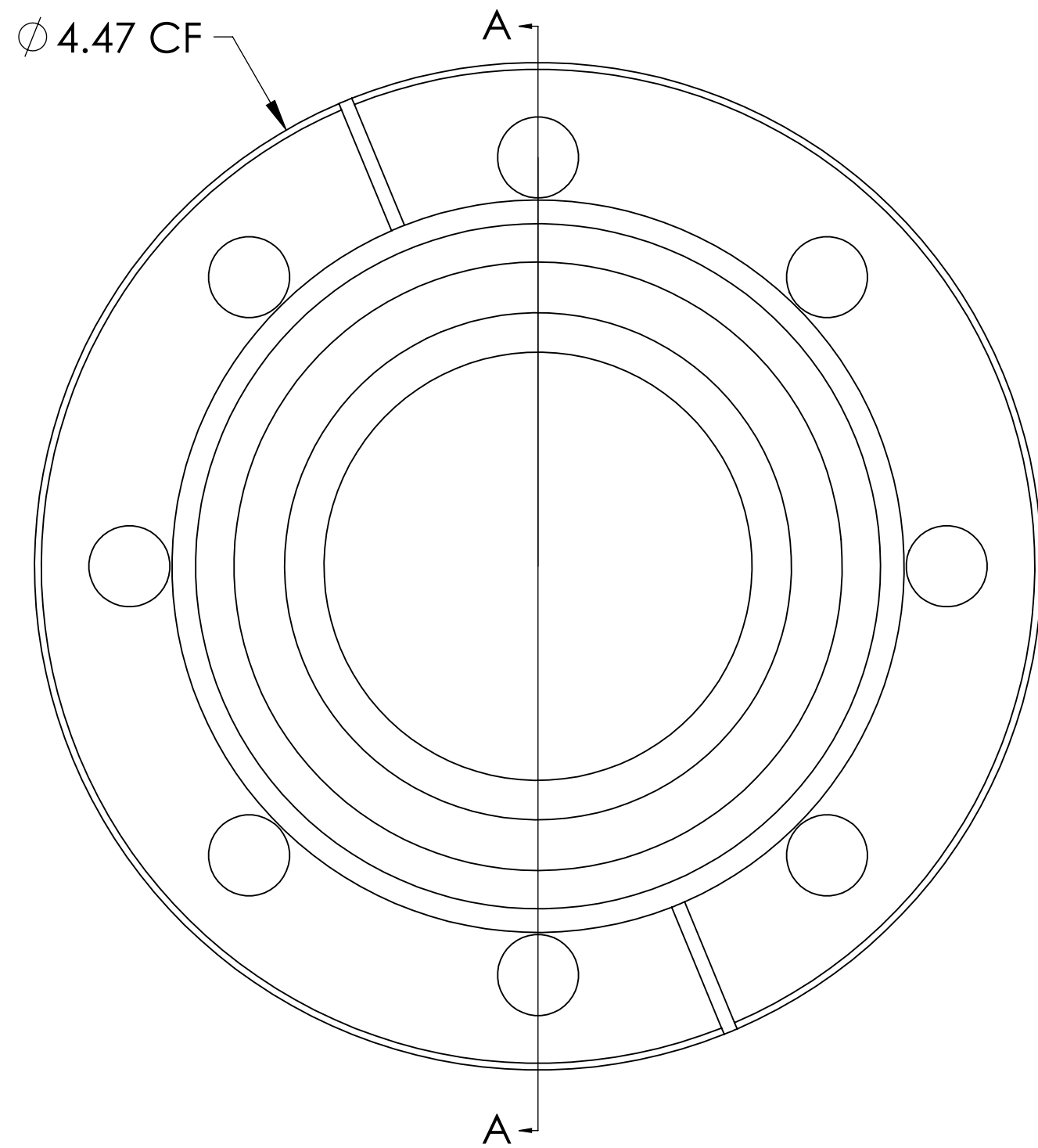

SPECIFICATIONS:

1. MATERIAL: EXCIMER GRADE SINGLE CRYSTAL, 0° CALCIUM FLUORIDE 157 GRADE
2. FLATNESS <math>< \lambda/2 @ 632\text{NM}</math> (PEAK TO VALLEY)
3. PARALLELISM <math>< 3</math> ARC MINUTES
4. SURFACE FINISH: 20/10 SCRATCH-DIG
5. THERMAL RANGE: -100°C TO 200°C
6. LEAK RATE <math>< 1 \times 10^{-9}</math> ATM-CC/SEC HE

Calcium Fluoride (CaF2) Viewport, 157 Grade, UHV Rated Vacuum-Optics, 1.88" View Dia, 4.50" Conflat Flange

UNLESS OTHERWISE SPECIFIED:	QUOTATION #	N/A	
DIMENSIONS ARE IN INCHES TOLERANCES:	DRAWN	NAME	DATE
ANGULAR: MACH ± 1/2°	WJ	WJ	9/11/2015
TWO PLACE DECIMAL ± .030	CHECKED		9/11/2015
THREE PLACE DECIMAL ± .015	ENG APPR.	WJ	9/11/2015
MATERIAL	THIRD ANGLE:		
FINISH	APPLICATION		
PLATING	NEXT ASSY USED ON		
	SURFACE FINISH: 63 OR BETTER		
	UNLESS OTHERWISE SPECIFIED:		
	ALL DIAMETERS CONCENTRIC WITHIN .005. REMOVE ALL BURRS AND SHARP EDGES		
	TITLE:		REV
	VIEWPORT, 157 CAF2 VACUUM OPTICS, 2" VIEW, 450CF		
	DWG. NO.		
	A6772-1-CF		
	DOWNLOADED FROM MPFPI.COM		
	Wednesday, October 14, 2020 11:24:11 AM		