

MPF PRODUCTS INC.

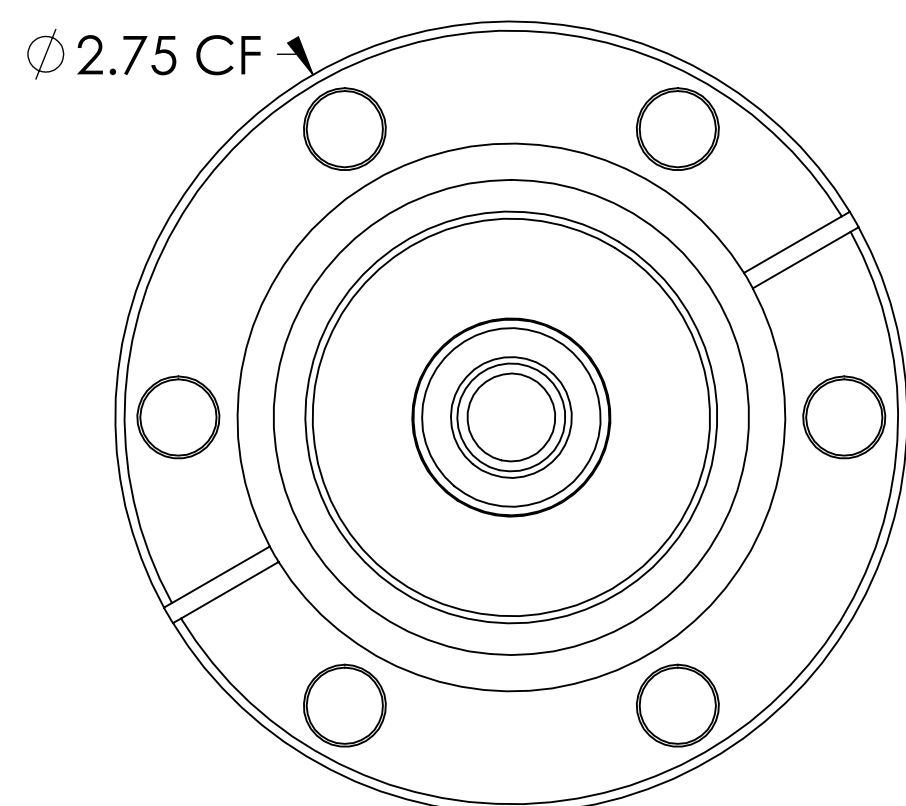

Ø .375±.002
.035" WALL
COPPER

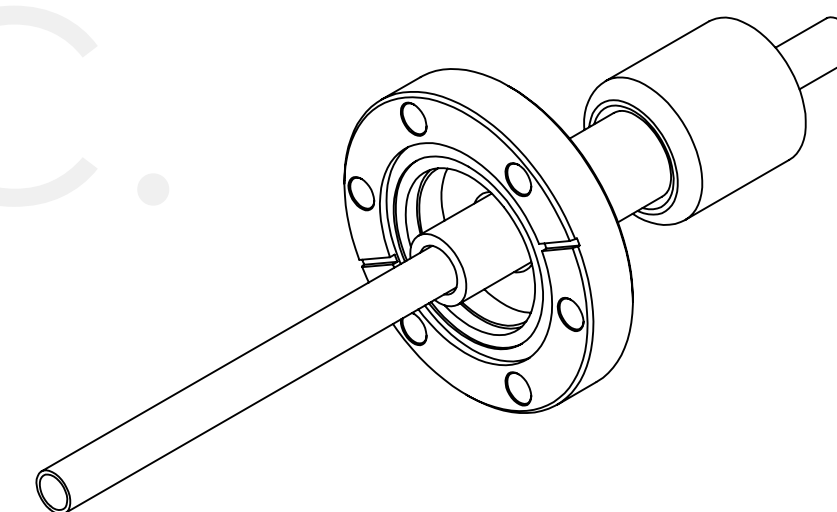
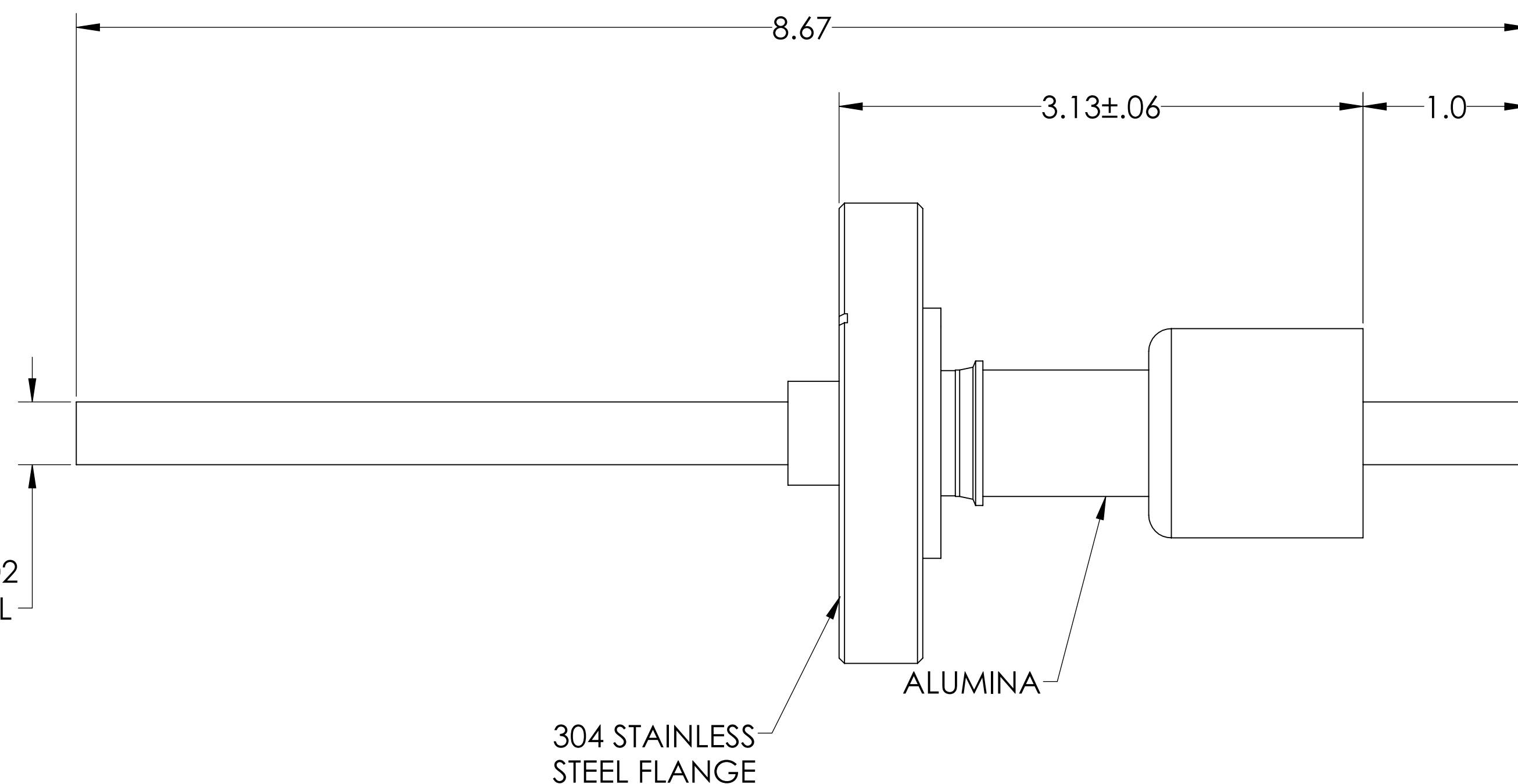

NOTE:

1. VOLTAGE: 10,000 VOLTS DC
2. CURRENT: N/A
3. TEMPERATURE RATING: -100 TO 450°C

RF Power Feedthrough, 10000 Volts, 35 KW @ 13.56 MHz, 1 Tube, 0.375" Copper Conductor, 2.75" Conflat Flange, UHV Rated, Bakeable to 450°C

UNLESS OTHERWISE SPECIFIED:	QUOTATION #		N/A
DIMENSIONS ARE IN INCHES TOLERANCES:	NAME	DATE	MPF PRODUCTS INC.
ANGULAR: MACH ± 1/2°	DRAWN	9/11/2015	
TWO PLACE DECIMAL ± .030	CHECKED	9/11/2015	
THREE PLACE DECIMAL ± .015	ENG APPR.	9/11/2015	
MATERIAL	THIRD ANGLE:		RF POWER FEEDTHROUGH, 10 KV, 35 KW, 1 TUBE, 2.75" CONFLAT FLANGE
FINISH			
PLATING	APPLICATION NEXT ASSY USED ON		
	SURFACE FINISH:	63/ OR BETTER	DOWNLOADED FROM MPFPI.COM DWG. NO. REV
	UNLESS OTHERWISE SPECIFIED:		A1731-1-CF
	ALL DIAMETERS CONCENTRIC WITHIN .005. REMOVE ALL BURRS AND SHARP EDGES		Wednesday, June 30, 2021 1:48:48 PM