

MPF PRODUCTS INC.

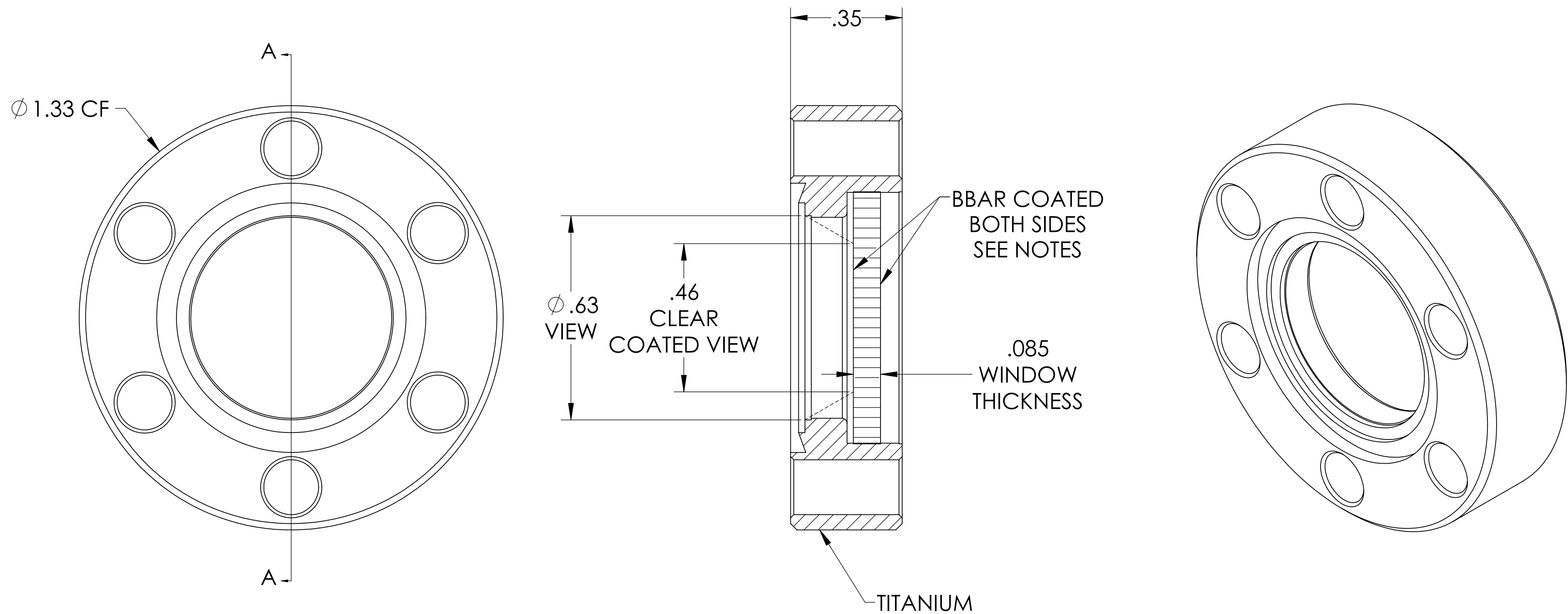

SPECIFICATIONS:

1. MATERIAL: CORNING HPFS 7980 FUSED SILICA
2. TWD <math>< \lambda/4 @ 632\text{nm}</math> (PEAK TO VALLEY)
3. PARALLELISM <math>< 10</math> ARC SECONDS
4. SURFACE FINISH: 20-10 SCRATCH-DIG
5. THERMAL RANGE: -100°C TO 200°C
6. HOMOGENEITY GRADE: A
7. INCLUSION CLASS: 0
8. BBAR COAT BOTH SIDES AT 780-795nm
9. $R < 0.25\%$ PER SURFACE AT 780-795NM
10. LEAK RATE <math>< 1 \times 10^{-9}</math> ATM-CC/SEC HE

Laser Grade Fused Silica Viewport, BBAR Coated 780-795nm, 0.63" View Dia, 1.33" Titanium Conflat Flange

UNLESS OTHERWISE SPECIFIED:	QUOTATION #	N/A	
DIMENSIONS ARE IN INCHES TOLERANCES:	DRAWN	NAME	DATE
ANGULAR: MACH $\pm 1/2^{\circ}$	WJ	WJ	9/11/2015
TWO PLACE DECIMAL $\pm .030$	CHECKED		9/11/2015
THREE PLACE DECIMAL $\pm .015$	ENG APPR.	WJ	9/11/2015
MATERIAL	THIRD ANGLE:		
FINISH	APPLICATION		
PLATING	NEXT ASSY	USED ON	
	SURFACE FINISH:	63 OR BETTER	
	UNLESS OTHERWISE SPECIFIED:	ALL DIAMETERS CONCENTRIC WITHIN .005. REMOVE ALL BURRS AND SHARP EDGES	
	TITLE:	VIEWPORT, FUSED SILICA, LASER GRADE, BBAR COATED, 780-795NM 0.63" VIEW, TITANIUM 133CF	
	DWG. NO.	A25404-1-CF	
	REV		
	THURSDAY, DECEMBER 11, 2025 3:22:17 PM	DOWNLOADED FROM MPFPI.COM	